

Courses & Distances from  
W. Thorn to 5<sup>th</sup> on Clear-  
field Creek.

- S. 62 E 100
- N. 74 E 76
- N. 52 E 42
- N. 84 E 22
- S. 41 E 10
- S. 38 E 44
- East 77
- S. 46 E 18 Creek
- S. 24 W 39
- S. 10 E 52
- S. 63 E 20
- N. 70 W 58
- S. 85 W 61
- S. 2 W 157.

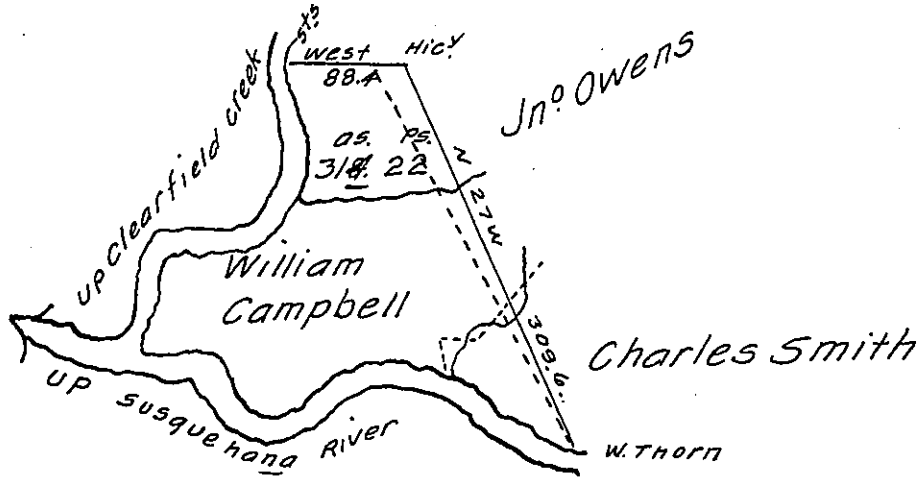

Draught of a Tract of Land Situate in Clearfield County. Lawrance Town-  
ship at Mouth of Clearfield Creek and Joining the West Branch of Susque-  
hanna River. Containing Three Hundred and fourteen Acres, Twenty Two  
Perches and the Usual Allowance of Six per Cent for Roads &c. Surveyed  
the 9<sup>th</sup> Day of Octo<sup>r</sup> 1828 in pursuance of an Application N<sup>o</sup> 2744. Granted  
to William Campbell for 300 acres.

To Gabriel Heister Esq<sup>r</sup> David Ferguson -  
Surveyor General

Noate. the Above Survey Interfers 30 acres with John Owens Warrant Dat<sup>d</sup>  
the 14 Nov<sup>r</sup> 1807. Surveyed 1810 & 50 Acres with Charles Smith Application N<sup>o</sup>  
2449. Dat<sup>d</sup> 1769. Surveyed 10<sup>th</sup> July 1769 and the Remainder Interfers with  
John Brown Appli<sup>n</sup> Dated 3<sup>rd</sup> Apr<sup>l</sup> 1769. N<sup>o</sup> 1357. Resurveyed 14<sup>th</sup> Octo<sup>r</sup> 1802  
occupied by John @line, Mathew Ogden & Isaac Goon. Partialy Surve-  
yed, being part of a Body of Surveys.

Jno. Owens. pat<sup>d</sup> D.F.  
N<sup>o</sup> 2449. pat<sup>d</sup>  
N<sup>o</sup> 1357. pat<sup>d</sup>

IN TESTIMONY that the above is a copy of the original remaining on file in  
the Department of Internal Affairs of Pennsylvania, made  
conformably to an Act of Assembly approved the 16th day of  
February, 1833, I have hereunto set my Hand and caused  
the Seal of said Department to be affixed at Harrisburg,  
this fifth day of February 1909.

*Henry Howell*  
Secretary of Internal Affairs.